

On & inside the studio ...

JOURNAL # 01



ARCHITECTS

Caph Building Studio

Note for Digital version

This is a digital version of the book.
Please reach out to the author to request for its physical copy.
No portion of this book may be reproduced in any form,
without written permission from the author.

Journal # 01

Topic	On & inside the studio ...
Author	Caph Building Studio, LLP
Date	March 2023

Stories that build design builds you ...



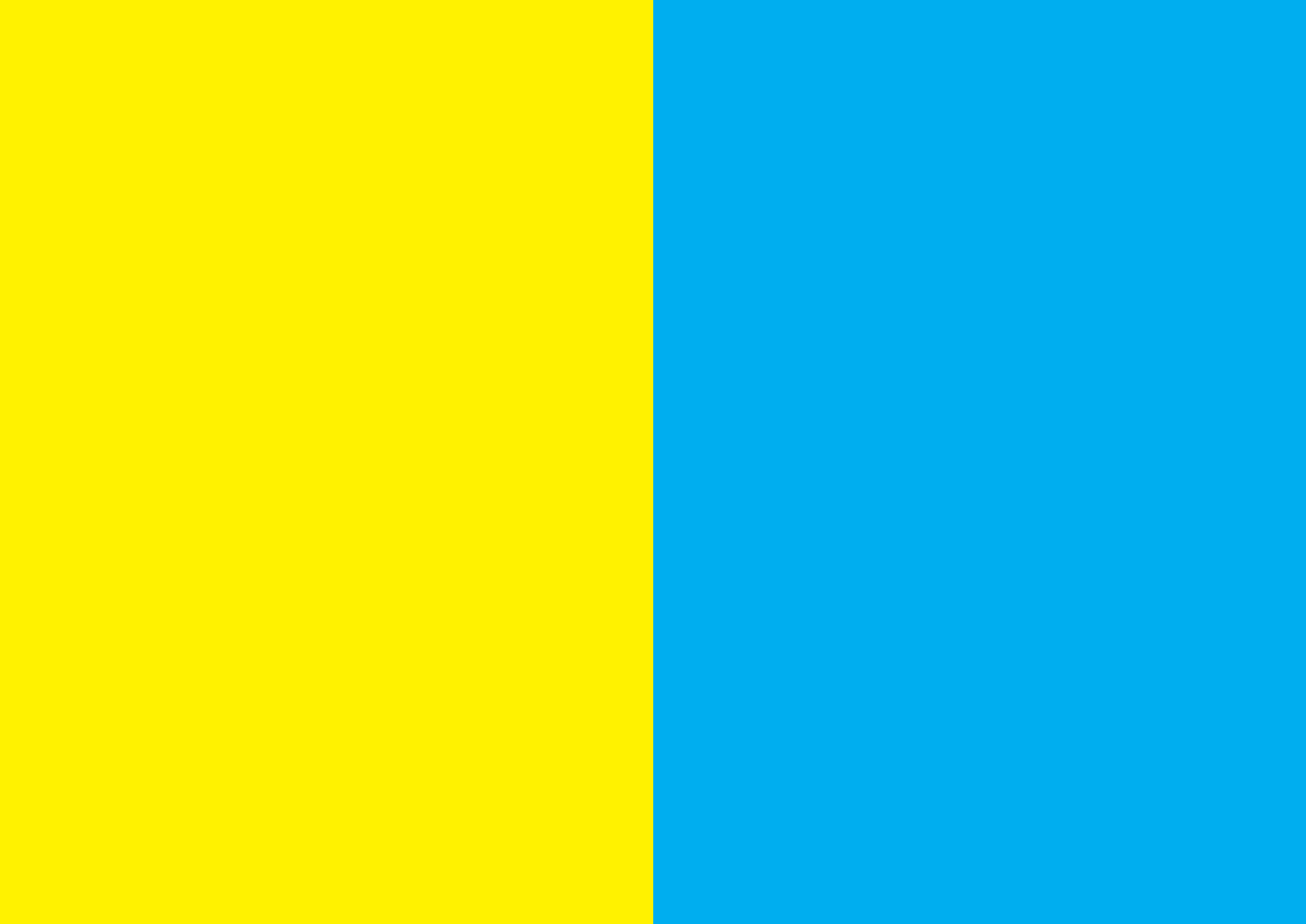

I get inspiration from my everyday life



To keep up with the quality of his films, the inspiration from everyday life captures the interest of Hayao Miyazaki.

He moves away from his desk to capture people's emotions. Daily, a bench is put outside his studio to observe people sitting. Also, a camera inside his car would record street life while traveling. He is known to create a magical world of imagination around the routine of everyday life. He works to find the extraordinary from the ordinary.

In November 2022, Caph Building Studio felt the beauty within this everyday life. And to journal its contents across the contemporary world of architecture. This journal works to find ideas on better ways of living.

Hayao Miyazaki is the co-founder and director of Studio Ghibli (a Japanese animation studio). He is one of the most well-known global personalities considered to make quality films.

The Bench - A still from the documentary film *10 Years with Hayao Miyazaki*.



				12 READERS' NOTE	16 INTRODUCTION TO JOURNAL # 01	18 COLORS, TEXTURES, AND EMOTIONS
				This book is a collection of ideas on appropriate practices in design fields.	Are architects explored to design for better living or to shape luxury?	Why do colors matter to us?
04	22 FOCUS WORK					
	Mr. & Mrs. Rumane shifted ... to meet their desired and specific values in living.					
05	36 OTHER WORKS					
	Current / 2020 - 2022 Part of work process Earlier / 2011 - 2020					
06	42 UPCOMING PROJECT					
	Self-development of Community-focused Residences					
07	44 COMMUNITY-FOCUSED ARCHITECTURE					
	Ways to develop ... private, private community, self ... community-focused					
08	48 RESOURCES & CREDITS					
09	50 STUDIO PROFILE					
	Caph Building Studio offers design services and construction consultancy ...					

01 / READERS' NOTE

A note to our readers –

This book is a collection of ideas on appropriate practices in design fields. It mainly focuses on architecture, interior, and landscape. And on other areas related to design.

My presence as a practicing architect and educator in the design field started in 2011. It informs me that our society needs a search for new forms of living environments. Such needs appear from society's advancement around 2000 in two areas. With digital technologies, we are updating our ways of living and working. And with migration, people are coming closer to cities, with rising social differences between them. It results in less usable present forms of development.

These concerns are worthy of discussion if our investments in time and money expect appropriate developments. Design today can combine social science with technology to aim for better changes in our living, working, and socializing. A designer's role in this is not limited to luxury but also to handle affordability.

With this book, *Caph Building Studio* works to bring ideas on appropriate practices to people and deal beyond aesthetics. It should help us to relook at our developments or to shape their newer ideas - the buildings, their interiors, and the landscape around them. It serves as a journal of ideas and aims for its regular release with the title *Caph Building Studio*.

Samir Bagdadi
Founder & Architect
Caph Building Studio

कुछ शब्द हमारे पाठकों के लिए:

काफ बिल्डिंग स्टुडियो नामक पत्रिका का यह संस्करण कुछ समुचित एवं रचनात्मक अभिकल्पनाओं का संग्रह है। यह मुख्यरूप से वास्तुकला, भवनों के आंतरिक रूप तथा उनकी वातावरणीय दृश्यभूमि पर केन्द्रित है।

मेरा वास्तुकला से व्यवसायिक एवं शिक्षक के रूप में जुड़ाव वर्ष २०११ से शुरू हुआ था। इस अनुभव से मैंने जाना की नए और प्रगतिशील सामाजिक परिवेशों और उन्नति की हमारी खोज निरंतर बनी हुई है। वर्ष २००० के करीब से तो हमारे समाज के अति प्रगतिशील विकास के चलते, विशेषकर दो क्षेत्रों में इस आवश्यकता में और गति आई है। डिजिटल टेक्नालजी के चलते हमारे रहन सहन और रोज़गार के तरीके तेजी से बदल रहें हैं अथवा निरंतर स्थानांतरण के जरिये लोग शहरों और शहरी रहन सहन के नज़दीक आ रहे हैं। ऐसे में शहरी समाज में समुदायिक विविधता बढ़ी है तथा पुरानी सामाजिक एवं इमारती व्यवस्थाओं की उपयोगिता घटी है।

ऐसी परिवर्तनशीलता के लिए यथोचित चिंतन अति आवश्यक है, यदि हम अपने समय और सम्पदा के निवेश का अनुकूल परिणाम और लाभ चाहते हैं। आज की हमारी वास्तुशिल्पीय एवं शहरी निर्माण की रचनाएँ , सामाजिक विज्ञान को तकनीकी विकास से जोड़ते हुए समाज के रहन सहन, रोज़गार और सामूहीकरण की जरूरतों को बेहतर तरीके से पूरा कर सकती हैं। ऐसे में वास्तुकार/डिज़ाइनर की भूमिका और व्यवसाय केवल समृद्ध जीवनशैली वाले जनसाधारण तक ही सीमित न होकर, हर जीवनशैली के आर्थिक सामर्थ्य के अनुसार साधन देने की हो ।

काफ बिल्डिंग स्टुडियो संस्था का इस और भविष्य में छापे जाने वाले संस्करणों के जरिये इस दिशा में, कुछ ऐसी ही समुचित कल्पनाओं और रचनाओं की तरफ ध्यान आकर्षित करने का यह एक प्रयास है। आपको वास्तुकला, भवनों के आंतरिक रूप तथा उनकी वातावरणीय दृश्यभूमि के व्यवसाय से जुड़े पिछले, ज़ारी और नए कार्यों पर पुनर्विचार और मंथन की ओर प्रेरित करने के उद्देश्य से यह पत्रिका काफ बिल्डिंग स्टुडियो छापी जा रही है।

समिर बगदादी
संस्थापक एवं वास्तुकार
काफ बिल्डिंग स्टुडियो

قارئین کے لیے پیغام

یہ کتاب متعلقہ عملی ڈیزائن کے طریقوں پر خیالات کا مجموعہ ہے۔ یہ بنیادی طور پر فن تعمیر، آرکیٹیکچرل ڈیزائن، اور زمین کی تزئین اور ڈیزائن سے متعلق دیگر شعبوں پر توجہ مرکوز کرتی ہے

میں نے اپنی عملی زندگی کا آغاز 2011 میں ایک آرکیٹیکچرل ڈیزائنر اور ڈیزائن انجینئرنگ کے شعبے میں استاد کے طور پر کیا۔ اور میں نے اپنے عملی سفر سے سیکھا کہ ہمارے معاشرے کو ماحول دوست رہائش کی نئی شکلیں تلاش کرنے کی ضرورت ہے۔ یہ ضرورت سن 2000 سے معاشرے کی دو شعبوں میں ترقی سے ظاہر ہوئی اور تکنیکی علوم کے ساتھ ہم نے اپنے رہن سہن اور زندگی میں کام کرنے کے طریقے تیار کرنا شروع کر دیے۔ خاص طور پر بڑے شہروں کی طرف لوگوں کی ہجرت کے بعد ان کے درمیان بڑے پیمانے پر سماجی تبدیلیاں پیدا ہوئیں، اور یوں ترقی کی کم مفید صورتیں پیدا ہوئیں۔

یہ خدشات قابل بحث ہیں اگر ہمارے وقت اور مال کی سرمایہ کاری مناسب ترقی میں لگنا متوقع ہے۔ آج کے ڈیزائنرز کو سوشل سائنس اور ٹیکنالوجی سے مربوط کیا جاسکتا ہے تاکہ ہم ہماری زندگی، کام کرنے کے طور طریقوں، اور معاشرہ کی بہتری کے مقصد تک پہنچ سکیں۔۔ اور اس سلسلے میں ایک ڈیزائنر کا کردار صرف لگزری سہولیات کی فراہمی تک ہی محدود نہیں رہتا بلکہ لاگت سے بچنے کی صلاحیت بھی اسکی ذمہ داری ہے۔۔

کاف ف بیلڈنگس اسٹوڈ اس کتاب کے ذریعہ لوگوں کے لیے مناسب طریقوں کے بارے میں خیالات فراہم کرنے اور جمالیات سے بالاتر چیزوں سے نمٹنے میں ان کی مدد کرنے کے لیے کام کرتا ہے۔ یہ آپ کو اپنی پیش رفت پر نظر ثانی کرنے اور لوگوں کے نئے آئیڈیاز ، ان کے ارد گرد کی عمارتیں، اندرونی اور بیرونی مناظر کو شکل دینے میں بھی مدد کرتا ہے - یہ نظریاتی جریدے کے طور پر کام کرتا ہے اور ”کاف بیلڈنگس اسٹوڈ“ کے عنوان سے اس کی باقاعدہ اشاعت ہمارا مقصد ہے۔

سمیر بغدادی
مؤسس وڈیزائنر
کاف بیلڈنگس اسٹوڈ

Communication message / We write the 'Readers' Note' to this journal in seven different languages to maximize reaching out to our known readers. Nevertheless, we would welcome your request to see this note in your preferred language other than included in this issue. Your request should reflect in our upcoming journal issue.

'Journal # 01' is the first release of the series titled Caph Building Studio. Therefore, it only is an introduction to the studio. From 'Journal # 02', the other sections may interest you,

आमच्या वाचकांना एक टीप –

हे पुस्तक म्हणजे डिझाईन क्षेत्रातील योग्य पद्धतींवरील कल्पनांचा संग्रह आहे. यात प्रामुख्याने आर्किटेक्चर, इंटरिअर, लँडस्केप आणि डिझाइनशी संबंधित इतर क्षेत्रांवर लक्ष केंद्रित केले आहे.

डिझाइन क्षेत्रात सराव करणारा आर्किटेक्ट आणि शिक्षक म्हणून माझी कारकीर्द २०११ मध्ये सुरू झाली. हे मला सूचित करते की आपल्या समाजाला नवीन प्रकारच्या सजीव वातावरणाच्या शोधाची आवश्यकता आहे. अशा गरजा दोन क्षेत्रांत २००० च्या सुमारास समाजाच्या प्रगतीतून दिसून येतात. डिजिटल तंत्रज्ञानाद्वारे, आम्ही आमच्या जगण्याच्या आणि कार्य करण्याच्या पद्धती अद्ययावत करीत आहोत. आणि स्थलांतरामुळे, लोक शहरांच्या जवळ येत आहेत, त्यांच्यातील सामाजिक मतभेद वाढत आहेत. याचा परिणाम विकासाच्या कमी वापरण्यायोग्य वर्तमान प्रकारांमध्ये होतो.

जर आपल्या वेळ आणि पैशातील गुंतवणूकीला योग्य विकासाची अपेक्षा असेल तर या चिंता चर्चेस पात्र आहेत. आजची रचना सामाजिक विज्ञान आणि तंत्रज्ञानाची सांगड घालू शकते, जेणेकरून आपले राहणीमान, काम आणि समाजीकरण यात चांगले बदल घडून येतील. यामध्ये डिझायनरची भूमिका केवळ चैनीपुरती मर्यादित न राहता परवडण्याजोग्या गोष्टी हाताळण्यासाठीही आहे.

या पुस्तकाद्वारे, कॅफ बिल्डिंग स्टुडिओ योग्य पद्धतींविषयीच्या कल्पना लोकांपर्यंत पोहोचविण्याचे आणि सौंदर्यशास्त्राच्या पलीकडे जाण्यास मदत करण्यासाठी कार्य करते. तुमच्या घडामोडींकडे पुन्हा लक्ष देण्यास किंवा त्यांच्या नवीन कल्पनांना आकार देण्यास मदत केली पाहिजे - इमारती, त्यांचे अंतरंग आणि त्यांच्या सभोवतालचे लँडस्केप. हे कल्पनांचे जर्नल म्हणून काम करते आणि कॅप बिल्डिंग स्टुडिओ या शीर्षकासह त्याचे नियमित प्रकाशन करण्याचे उद्दीष्ट ठेवते.

समिर बगदादी

संस्थापक आणि वास्तुविशारद

काफ बिल्डिंग स्टुडियो

and you may wish to see them in a specific language. We would be happy to attend to your request here as well.

Your request should help us to construct ideas for a better living environment. Our readers may be from the developer, the builder, individuals, the community, and more. Some of these may find comfort in understanding our content through an alternate language.

अमारा पिर्य वायको माटे अेक आस नोध -

आ पुस्तक मां डिजाइन क्षेत्रांनी योग्य पर्यायो परना विचारोनी संग्रह छे. तेमां मुખ्यत्वे स्थापत्य, तेनुं आंतरीक, पराकृतिक दृश्य अने डिजाइन ना अनेक क्षेत्र पर ध्यान केंद्रित करवामां आयु छे.

मारी कारकिर्दीर डिजाइन क्षेत्र मां स्थपति अने शिक्षक तरीडे २०११ मां शरू थछ. मने आ क्षेत्र मां आवीने जाड़ा थछ डे आपड़ा समाज ने सुयोग्य पयार्वरड़ा मां वसवाट करावा नवी शोधनी जरूर छे. २००० नी साव नी आसपास जेम जेम समाज नी उन्नति थती गछ, अेम अेम अे क्षेत्र मां अेनी जरूरियातो नी जरूर जाड़ावा बागी. पडेलुं, डिजिटल टेकनोलोजी थी आपड़ा आपड़ा जीवन जीववानी अने कामगीरी ने अद्यतन अनावी रड्या छे. बीजू, शेडरो मां लोक समूह ना स्थलांतर थी रडेवासीओ वय्चे सामाजिक असमानता अने विविधता वधी रडी छे. आना परिधामे लोको आजना विकास ना स्वरूप नो पूरो उपयोग नथी करी शकता.

आ मुद्दो विचारवा योग्य छे डे आपड़ी मूडी अने समयनु बांधकाम नी पर्याति मां ज्यां रोकाड़ा कयर् छे, अेमां आपड़ा ने सुयोग्य परिधाम मणवुं जोछअे. आपड़ां व्यक्तिगत अने सामाजिक जीवन मां उचित अदबाव बाववा माटे टेकनोलोजी साथे सामाजिककरड़ा ना विज्ञान नी भूमिका पड़ा अछम छे. डिजाइनर नी भूमिका आमां मातर वैभवी अने मौजकरड़ा नी सुविधा न्हि परंतु लोकने परवड अेमाटे पड़ा छे.

आ पुस्तक, ‘काइ बिल्डिंग स्टुडियो’ नुं पर्यत्न छे डे मातर सुंदरता नी यथार् ना करता, योग्य पर्यायो पर विचारो लोको वय्चे बाववा मांगे छे. ते तमने तमारा विकासने इरीथी जोवामां अथवा तेमना नवा विचारो करवामां जेमडे छमारतो, तेमना आंतरिक बागो अने तेमनी आसपासना बेनुडसुडेपने आकार आपवामां मदद करथे. ते डेतुओ अने विचारोनी जरूर्व तरीडे सेवा आपे छे अने ‘काइ बिल्डींग स्टुडियो’ शीघर्क साथे तेना नियमित परकाशननो डेतु अने छे.

समिर બગદાદી

સ્થાપક અને સ્થપતિ

કાફ બિલ્ડિંગ સ્ટુડિયો

আমাদের পাঠকদের জন্য একটি মন্তব্য-

এই বইটি ডিজাইনের ক্ষেত্রে উপযুক্ত অনুশীলনের উপর ধারনার একটি সংগ্রহ। এটি প্রধানত স্থাপত্য , অভ্যন্তর এবং ল্যান্ডস্কেপের উপর দৃষ্টি নিবদ্ধ করে। এবং ডিজাইন সম্পর্কিত অন্যান্য ক্ষেত্রগুলিতে আলোকপাত করে।

ডিজাইনের ক্ষেত্রে একজন অনুশীলনকারী স্থপতি এবং শিক্ষাবিদ হিসেবে আমার উপস্থিতি ২০১১ সালে শুরু হয়েছিল। এই অভিজ্ঞতার মধ্য দিয়ে আমি বুঝতে পেরেছি আমাদের সমাজের জীব/পিরেবেশর নতুন ফর্ম গুলির জন্য অনুসন্ধান করা প্রয়োজন। এই ধরনের চাহিদা ২০০০ সালের দিকে, সমাজের অগ্রগতি থেকে দুটি ক্ষেত্রে দেখা যায়।ডিজিটাল যন্ত্রের সাহায্যে, আমরা আমাদের জীবনযাপন এবং কাজ করার উপায় আপেডট করছি এবং অভিবাসনের সাথে সাথে মানুষ শহরতলির কাছাকাছি আসছে, তাদের মধ্যে সামাজিক পার্থক্য বাড়ছে। এর ফলে বর্তমান উন্নয়নের ধরন কম ব্যবহারযোগ্য।

এই বিষয়গুলো আলোচনা যোগ্য। তবে আমাদের সময় ও অর্থ বিনিয়োগ করতে হবে যাতে উন্নয়ন যথার্থ (সঠিক) হয়। আজকের দিনে ডিজাইন কারিগরি এবং সমাজ বিজ্ঞান এক জায়গায় করে আমাদের জীবন যাপন ও কাজ সমাজজীবনে আরও ভালো বদল আনতে পারে। এখানে একজন ডিজাইনার ভূমিকা (role) শুধু বিলাসিতা নয় বরং নিজের ক্ষমতা অনুযায়ী কাজ করে যাওয়া।

এই বইয়ের সাহায্যে , Caph Building Studio মানুষের কাছে উপযুক্ত অনুশীলনের ধারণা আনতে এবং নান্দনিকতার ঊর্ধ্বে কাজ করতে সাহায্য করে। এটি আপনাকে আপনার উন্নয়নগুলিকে পুনর্বিবেচনা করতে বা তাদের নতুন ধারণা গুলিকে রূপ দিতে সাহায্য করবে - বিল্ডিং , তাদের অভ্যন্তরীণ এবং তাদের চারপাশের ল্যান্ডস্কেপ। এটি ধারণা গুলির একটি জার্নাল হিসেবে কাজ করে এবং Caph Building Studio শিরোনামের সাথে এটির নিয়মিত প্রকাশের লক্ষ্য রাখে।

সামির বাগদাদী

প্রতিষ্ঠাতা ও স্থাপতি

Caph Building Studio

رسالة للقراء

هذا الكتاب عبارة عن جمع من الأفكار حول ممارسات عملية ملائمة لمجال التصميم. ويركز بشكل أساسي على الهندسة المعمارية، والتصميم الداخلي، والمناظر الطبيعية. وفي مجالات أخرى متعلقة بالتصميم

بدأ حياتي العملية من عام 2011م كمصمم معماري ومدرس في مجال الهندسة التصميمية. وتعلمت من خلال رحلتي العملية بأن مجتمعنا يحتاج إلى البحث عن الأشكال الجديدة للسكن الملائم للبيئة. وقد بدا هذا الاحتياج من تقدم المجتمع من عام 2000م إلى مجالين، ومع العلوم التقنية بدأنا نتطور طرق عيشنا وطرق عملنا في الحياة. وخاصة بعد هجرة الناس إلى المدن الكبيرة الأمر الذي أوجد فروق اجتماعية بينهم بشكل كبير، وبالتالي نتج عن ذلك أشكال التنمية الأقل استخداما

وهذه المخاوف جديرة بالنقاش إن كان استثمارنا في الوقت والمال يتوقع بالتنمية المناسبة. والتصميم اليوم يمكن ان يلحق بالعلوم الاجتماعية وبالتقنية للوصول إلى هدف يوحى إلى التغيير الإيجاري في عيشنا وعملنا ومجتمعنا. ولم يقتصر دور المصمم على الرفاهية فحسب بل ودوره أيضا التعامل مع قدرتنا على التكلفة

مع هذا الكتاب، يعمل ”كاف بيلدنغز استوديو“ على تقديم أفكار حول الممارسات المناسبة للناس والمساعدة في تعاملهم مع ما هو وراء الجماليات. كما يساعدك في إعادة النظر حول التطورات الخاصة بك أو تشكيل أفكار الناس الجديدة - المباني والديكورات الداخلية والمناظر الطبيعية من حولهم. وهي بمثابة مجلة للأفكار وتهدف إلى إصدارها المنتظم بعنوان ”كاف بيلدنغز استوديو“

سمیر بغدادی

مؤسس ومصمم

کاف بیلدنغز استودیو

02 / INTRODUCTION TO JOURNAL # 01

*Are architects explored to design for
better living or to shape luxury?*

This journal suggests that they benefit people at best in attending to both. They look for a *balance* between 'better living' and 'luxury' that is important in people's living, working, and socializing.

'Journal # 01' is the first release from this series. Its purpose is to introduce Caph Building Studio and is, therefore, titled *On and Inside the Studio*.

It attempts to explain this balance through nine sections in this issue. Sections 01 & 02 introduce the journal series and inform the purpose of this issue release. Sections 03 & 09 gives an overview of the studio with a short essay to gain insight into its thinking on balance.

Sections 04, 05, and 06 display works - the current, the process, and the earlier. The works in 'current' and 'process' reflect the studio's design thinking. And sections 07 and 08 serve as support. Section 07 collects specific work from different parts of the world that discuss architecture toward community development.

03 / COLORS, TEXTURES, AND EMOTIONS



Stone / **Blue Onyx**
Rumane Residence



Leaves / **Sun, Wind, and Sound**
Kulkarni House



Veneer / **Vertical Grains**
S-N Bagdadi Residence



Laminate / **Angular Grains**
Kudalkar Residence

Why do colors matter to us?

We take care to have them on and around us. Does it improve our way of living? Or makes us work better? Or it adds value to our social presence? However, we have a reason for colors. If only we knew where our choices come from, we would choose them well.

According to some design critics and scholars, we can link our choices to emotional, intellectual, and believed sources. Around 200 years ago, studies began to look at how they matter to humans. Their studies are still progressing. Interest in colors started in our far past and continues in our present.

THE THREE SOURCES OF OUR COLOR CHOICES

The Emotional - Imagine that our emotions in color may come from people connected with our past 10 generations - about 200 years. Whether our past influences are near-past, far-past, or beyond these 200 years, we unknowingly seek emotional reasons in colors as a sense of belonging. Such a sense recalls our emotional connection to our social background.

For example, people who honored the sun found them inclined to orange or red. People who resided in deserts craved green to imagine themselves close to nature. These are examples of the far past. People born around the 1980s may associate themselves today with the color sepia. That is near past. These colors allow us to reach back to our social background and understand the meaning of our desires in the present.

The Intellectual - Other than the past, colors equally reflect our present. Through colors, we want to inform others about how valuable we are to the society around us for most of our daily time. Or silently project our pride in social or economic class.

For example, the color red in the Youtube logo speaks of energy to bring lots of content to us. It holds the interest of most, including children who are yet to develop speaking abilities. The warm colors may express our **strength-energy**, **success-commitment** or **happiness-intelligence**. And in cool colors,

we may show our **trust-confidence**, **freshness-balance**, or **royalty-wealth**. Through these colors, we reveal a sense of our capability to society.

The Believed - Beyond emotional and intellectual, colors also matter to us to be a part of ongoing popularity. Being amongst them may make us feel happy, proud, successful, and other such feelings. We may not necessarily have a reason for it. We may want to project our unreal or dream image through colors. It is because we strongly believe in them.

For example, the color pink commonly predicts gender. It is not a common color choice for males. Instead, it is a statement they may want to make if they go for pink. They may indicate that boys do not want to tie to gender-based roles in society. Through such choices, we may feel a sense of achievement.

COLORS AND MORE

Colors silently influence our places of living, working, and socializing. Likewise, the materials we use, the spaces, furniture and objects, the ambiance, and more can communicate much about us to others or influence us.

And likewise, the fashion we wear, the products we use, the colors and textures in photographs we display, the graphics our work uses, and more would require attention. Their respective designers think of achieving a balance from the choices we make. We take care to choose them to build our stories.

Colors and more make our stories unique to make sense of us and our environments, daily and occasionally. In various ways, we communicate through them with others and ourselves.

Colors and more, matter to us to communicate with our senses in order to shape us well.

Top / Ruman Residence
Bottom / S-N Bagdadi Residence



Top / Kulkarni House
Bottom / Kudalkar Residence





RUMANE RESIDENCE



The Residence / Mr. & Mrs. Rumane shifted to Ulwe with an intent to meet their desired and specific values in living. The luxury and living standards are their starting directions in design to craft their idea of home.

This 800 square feet, 2-BHK apartment intends to be their permanent residence. It faces south and builds a delightful quality of spaces with natural light. The owners require this delight to retain. In addition, an increase in storage capacity for their routine use requires meeting the new luxury statement.

The furniture design answers their routine use, the lighting for day and evening attends to their works and moods, and the colors and materials reflect a contemporary and clean ambiance. All these intend to craft their idea of home.

The Living & Dining / The design combination in furniture, lighting and false ceiling works differently with day and evening. It focuses on controlling the room's ambiance. It serves their luxury and their varied functions, including large gatherings.

The main door, wall paneling, and the T.V. unit construct a single design element forming a visually clean ambiance to make the room appear large. The materials enhance the required focus to experience richness in their natural textures - satvario marble and blue onyx, veneer, and steel-grey fabrics sandwiched between the ivory of the floor and ceiling.

The set of furniture this room holds should allow a 15-person seating capacity and two persons to sleep using sofa-cum-bed. The aesthetics contributing to the room's ambiance is an outcome of the client's varied functional needs.



The Entrance & The Mirror / The mirror near the entrance has a different fuction than at any other point in the residence. Here, it lets the entering person see the moods they bring with them.



Part of work process / The marble slab that is part of the TV unit and wall panelling curves down to form a seating with storage below. It's construction involved careful detailing, sampling, and co-ordination between multiple teams - carpentry, civil, and electrical. Desired results of complex elements are an outcome of well-worked drawings.



The Kitchen / Here, the design challenge was to achieve about 2.5 times more storage than the existing functional one. All the work and storage elements for the client's needs are tailored based on daily, monthly, and occasional needs. The elements, such as hand-made ceramic wall tiles, an inbuilt soap holder, lighting, and a combination of laminates, come together to make the space feel broad.



Part of work process / The use of hand-made tiles was central to shaping the kitchen ambiance. A set of digital drafts to see its effects on space develops the confidence to chose the right one.



The Parent's Bedroom / It anticipates its use of intermittent resting and serves as an extension for occasional family gatherings. In addition, it needs to hold about 1.4 times its existing storage capacity. The wardrobe holds 90% of the room's storage, clearing the space from any visual clutter. The cream colored walls with sunlight from the south build a calm ambiance serving intermittent resting.



The Master Bedroom / It needs to hold 1.6 times its existing storage and serve as an extension for occasional family gatherings. A work/study area is an additional need. Storage is maximized in wardrobe, clearing the space from any visual clutter. The blue-colored wardrobe shutters with french wash on walls, build a relaxed psychological environment for working members of the apartment.





05 / OTHER WORKS

PROJECT LIST

- 1 / Dhriti Apartments, Mumbai, Maharashtra
- 2 / Kulkarni House, Bidar, Karnataka
- 3 / Chaurasia Residence, Mumbai, Maharashtra
- 4 / S-N Bagdadi Residence, Mumbai, Maharashtra
- 5 / Kudalkar Residence, Navi-Mumbai, Maharashtra



CURRENT WORKS / 2020 - 2022
After the studio's establishment in 2020, it has been working to extend skills within and beyond design fields. The *Current Works* focus on people and their complex layers of needs. Visual appeal is a result of well-organized functions.

For example, most works in this section searched for design inspirations in social science as it was a demand of those projects' nature. It helped to meaningfully shape environments for the studio's clients so that it speaks to them. Also, regular checks on the project cost helped reach healthy project completion. The visual appeal was a result of these efforts.

All works locate in India.



KUDALKAR RESIDENCE

OCT 2020 - DEC 2020

Part of work process

Client's Story / We're a three-member family residing in this 1-RK apartment. It is a small space that now feels something is lacking.

You see around! Our 1.5-year-old daughter enjoys scattering her toys. We find our storage insufficient to accommodate them. We now have space for things but have short space for us to live. And our common wall to kitchen & living is about to fall. It might add cost to construction.

Therefore we think we need to upgrade this apartment to feel livable. We intend to shift to another apartment after 3-5 years. Until then, this space is central to our living.

Architect's Story / We understand your intention to upgrade the ambience of this apartment. However, we see that the primary concern for interior design should be your daughter's experience when we plan here. Also, spaces bonding with you all at different times could answer living quality.

We observe that you have a camera fixed on a wall to see your daughter from your office throughout your workday. You have to leave her alone at home (with a babysitter) for an inevitable reason. It must be difficult for you.

If this continues, we see a social fault with a weak nostalgic value that builds your daughter's days until you shift 3-5 years from now. We need to attend to these social concerns and correct them with design

MOOD LIGHTS

OPTION 01 / IVORY WHITE

AFTER / ENTRANCE SIDE

Flap closed

OPTION 02 / PASTEL BLUE

OPTION 03 / PASTEL GREEN

AFTER / WINDOW SIDE

Flap closed

KUDALKAR RESIDENCE

OCT 2020 - DEC 2020

Part of work process

Client's Story / We're a three-member family residing in this 1-RK apartment. It is a small space that now feels something is lacking.

You see around! Our 1.5-year-old daughter enjoys scattering her toys. We find our storage insufficient to accommodate them. We now have space for things but have short space for us to live. And our common wall to kitchen & living is about to fall. It might add cost to construction.

Therefore we think we need to upgrade this apartment to feel livable. We intend to shift to another apartment after 3-5 years. Until then, this space is central to our living.

Architect's Story / We understand your intention to upgrade the ambience of this apartment. However, we see that the primary concern for interior design should be your daughter's experience when we plan here. Also, spaces bonding with you all at different times could answer living quality.

We observe that you have a camera fixed on a wall to see your daughter from your office throughout your workday. You have to leave her alone at home (with a babysitter) for an inevitable reason. It must be difficult for you.

If this continues, we see a social fault with a weak nostalgic value that builds your daughter's days until you shift 3-5 years from now. We need to attend to these social concerns and correct them with design

MOOD LIGHTS

OPTION 01 / IVORY WHITE

OPTION 02 / PASTEL BLUE

OPTION 03 / PASTEL GREEN





1-B

EARLIER WORKS / 2011 - 2020

Before the studio's establishment, the *Earlier Works* add skills to the studio within the building design field. It allows understanding of the nature of projects in the public and private, large and small, luxury and essential. Also, it informs on how to run a project from start to completion. Therefore, it introduces the market practices of design and construction.

Samir Bagdadi learned these skills from a few design firms as a project architect. Some works linked with firms 'Soyuz Talib Architects' and 'BBP Architecture Workshop' are displayed here.

All works locate in India.



2-A



3-B



4-A

PROJECT LIST

- 1 / Saraswati Heights, Mumbai, Maharashtra
- 2 / Patni Commercial Complex, Washim, Maharashtra
- 3 / Patil & Mhatre C.A. Office, Navi-Mumbai, Maharashtra
- 4 / Municipal Auditorium, Washim, Maharashtra
- 5 / Kesar's Polaris & Orion Residences, Mumbai, Maharashtra
- 6 / MBI Mall, Bhubaneswar, Odisha
- 7 / Palm Mall, Korba, Chhattisgarh
- 8 / Dinesh Jain Luxury Residence, Navi-Mumbai, Maharashtra

PROJECT CREDITS

- A / Soyuz Talib Architects, Pvt. Ltd.
Navi-Mumbai
- B / BPP Architecture Workshop
Navi-Mumbai



5-A



6-A



7-A



8-B



8-B

06 / UPCOMING PROJECT

UNITED RED HILLS

COMMUNITY-FOCUSED RESIDENCES, NAVI MUMBAI

SETTING AN IDEA

About every 25 years ...
A new generation is a blessing to a family.
A new set of requirements shape a residence.
A new set of values influence the culture of living.
Unlike earlier times, now change occurs faster ...
About every 25 years, a home needs the ability to change.

The measure of intelligence is the ability to change .

ALBERT EINSTEIN

THE PROJECT

United Red Hills is a set of residences planned to tailor through a self-development route initiated by the *Kokanis*. An inquiry to develop a project that suits their culture came to us, who look for people with equal values and interests in such homes. The design principles of flexible architecture are central to adapting to their present and future changes.

20 TAILORED APARTMENTS
BASIC, ADVANCED, AND CULTURE BASED AMENITIES
... AND MORE

07 / COMMUNITY-FOCUSED ARCHITECTURE

*A set of similar needs between people bring them close.
This closeness shapes a community.
A design focus on their needs builds a community-focused architecture.*

THE GENERAL AND THE NEW APPROACH

PRIVATE DEVELOPMENT
PRIVATE COMMUNITY DEVELOPMENT
SELF DEVELOPMENT

We require comfortable developments to meet our living needs. In them, we live, work, and socialize. For the past 30 years, a general approach was that property developers would build them. We then purchase a part of this development to fulfill our needs. Here, the main focus is on cost, amenities, and luxury that serve differently from project to project.

Other than the general one, we now see a new approach to development that answers community needs. There are two ways to do this. If they approach the developer, it is *Private Community Development*. At other times, a community builds on its own as a *Self-development*. Both these approaches are sensitive to the living quality of the community. The community is at the center of development.

FOCUSED APPROACH & EXAMPLE PROJECTS

CITY HYDE PARK, 2016
LA BORDA, 2018
THE SIX, 2016

Whether a property is developed privately or by self, the community's health comes from the *program in a project*. This section collects some examples of programs to build good health in a community. They should help you think beyond the general and the new approach, which is a focused approach.

These example projects inform how the community needs are at the center of their development. The occupants enjoy a tailored design to enhance their private and community life. The strategic planning in roof gardens, retail, residence layouts, walkways, common areas, courtyards, community gathering spaces, passive design, and more focus on community needs. Also, design strategies ensure low maintenance of the property and its energy use. It helps to improve building lifespan at a reduced cost.

CONTEXTUALIZING TO INDIA

These projects are responsive to culture, climate, people, and location. Their design programs are sensitive to needs. The design may not be suitable for us to use elsewhere other than its actual development. However, their intent in shaping community health is a lesson we can use as an idea to design for us.

To that, we ask for Community-focused Architecture!

City Hyde Park, USA, 2016 / Studio Gang Architects
1 / 180 units, balconies as social connection and thermal bridge between outdoor & indoor

2 / green roof & lobbies as community space, grocery store
3 / footpath widened along the plot set-back to compliment building's retail arcade

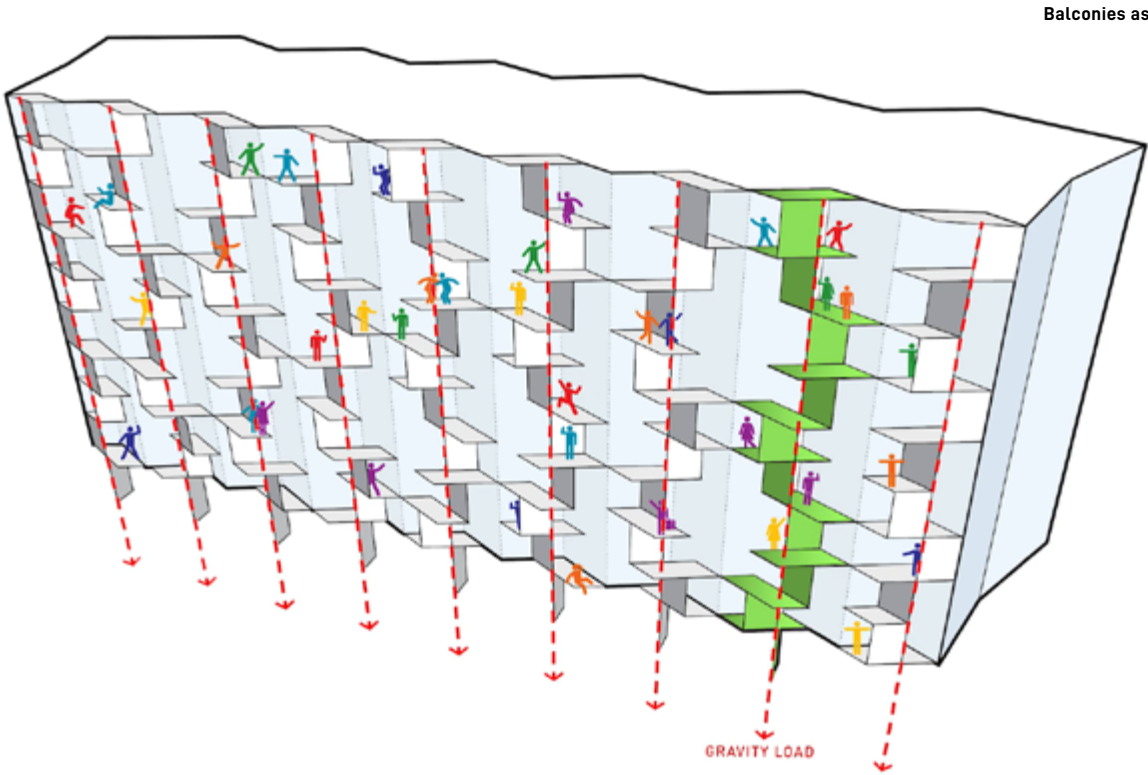

Balconies as social connection



La Borda, Spain, 2018 / Lacol Architects

- 1 / 27 units, private spaces to connect to community courtyard
- 2 / low building maintenance and energy use

- / water + energy + waste collectively as a passive design
- 3 / involvement of users in project stages - design, construction, use.



The Six, USA, 2016 / Brooks + Scarpa Architects

- 1 / 52 units, private studios + 1 bedroom apartments
- 2 / courtyard + greenroof together as community and

- neighbourhood spaces
- 3 / involvement of users in project stages - design, construction, use.



08 / RESOURCES & CREDITS

RESOURCES



Studio Abhishek Sawant

Studio Abhishek Sawant also known as SAS is a young photography studio led by Abhishek Sawant and Omkar Shemadkar. Shooting interiors, architecture and product commercials is our expertise. We are always keen on having a fresh approach for every assignment we chose to do and delivering something out of the box. Abhishek being an architect himself has a preconceived notion about the project with respect to its design and how its maximum potential could be presented in the best aesthetic manner.

Besides commercial works we also shoot documentary works. The start of both of our leaders into photography has begun from street photography along the streets of Mumbai. Our works on similar lines have been recognized on various national and international platforms.



Rearrange Homes

Your home is your haven, a sacred space where you can be your most authentic self. So it only follows that it should be an extension of who you are and aspire to be.

Re | Arrange, a one stop for house proud owners to curate a luxe home, thrives on just that.

The premise is as simple as the name suggests: your home can brighten up by the slightest additions - a few cushions here, a bed-runner there or a new throw for your chaise lounge.

The ideology behind every piece is to create a decor icon that is equal parts versatile and affordable.

CREDITS

Acknowledgement

Resources / Studio Abhishek Sawant and Re-arrange Homes are part of the support team for our project Rumane Residence. We respect their service beyond our project. It reflects faith, patience, and exploration. As a result, pleasing and customized outcomes serve clients.

Credits / All the contributors of this journal are duly credited. Any omissions should be a human error. Bringing them to our attention shall reflect in future issues.

Language Translations (Reader's Note)

Note of Appreciation / We reliably thank all who helped us with language translations. Their hands extend our reach to people beyond English readers, who align with the journal's social intentions. Their will is unique to our non-profit motive.

Arti Sharma / Hindi, Translator
Harsh Nag / Hindi, Proofread
Mohammed Athar / Urdu, Translator
Ibrahim Bagdadi / Urdu, Proofread
Vaishali Patil / Marathi, Translator
Harsh Nag / Marathi, Proofread
Jumana Biviji / Gujarati, Translator
Zainul Biviji, Jigna Panchal / Gujarati, Proofread
Probuddha Mukhopadhyay / Bengali, Translator
Shreejita Maity / Bengali, Proofread
Mohammed Athar / Arabic, Translator
Ibrahim Bagdadi / Arabic, Proofread

Support - Team for Rumane Residence

Note of Appreciation / A special thanks to all from the support team. Their patience with our work methods helps us tailor designs. Their experimentation in the delivery of services comes close to our design thinking. Overall, teaming with faith proves central to project success.

Wasim & Azra Rumane / Client
Caph Building Studio, LLP / Architects
Raj Interiors / Builder (Contractor)
Satyanarayan Gupta & Jeetlal / Carpentry Team
Ranjeet Yadav & Mahendra Saini / Civil Team
Re-arrange Homes / Bedding & Cushions
Piccolo Mosaic Ltd. / Handmade Tiles
Merino Industries Ltd. / Laminates
Mozart Vitrified Pvt. Ltd. / Full-body Vitrified Tiles
Camrola Quartz Ltd. / Quartz Slab
V-Lights / Light fixtures

Support - Funding for Journal # 01

Note of Appreciation / Several people from the 'Kokani' society came to us to understand residences grouped with like-minded people. Our multiple discussions on new ideas of homes across the globe gained their confidence. It led to the mid-way of the journal's interest to reach out to people with new ideas. We appreciate their visit, discussions, and optimism about new ideas. Respecting their patience, we provided a plan to set such a development. Responding to our act of respect, we earned funding for this cause. We express our great appreciation for their financial help that brought the possibility of this journal issue.

Ibrahim Bagdadi & Adil Bagdadi
Aslam Roomaney & Nauman Roomaney

Support - Intellectual Contents

Colors, Textures, and Emotions / Web-sources: Science of People (Color Psychology: What Colors Should You Wear and Why), Art Therapy Blog (Color Psychology: The Emotional Effects of Colors), London Image Institute (Color Psychology: How Do Colors Affect Mood & Emotions?), A Very Well Mind (Color Psychology: Does it Affect How You Feel?)

Community-focused Architecture / Web-sources: ArchDaily (Community), De Rosee Sa (What is 'Community' and the Role of Architecture in Shaping Communities?), Architizer (Building Connectivity: 7 Projects that Cultivate Closer Communities), University of Virginia, School of Architecture (The Mass Model of Community-focused Architecture), Re-thinking The Future (10 Best Examples of Community Architecture in the World)

The Bench / Web-source: NHK World, Documentary Film (10 Years with Hayao Miyazaki)

Designers and their Projects

Caph Building Studio, LLP / Rumane Residence, Kulkarni House, Kudalkar Residence, Chaurasia Residence, S-N-Bagdadi Residence, Dhriti Apartments (Residential Tower)
Soyuz Talib Architects Pvt. Ltd. / Patni Commercial Complex, Municipal Auditorium, Kesar's Polaris & Orion, MBI Mall, The Palm Mall
BBP Architecture Workshop / Saraswati Heights (Residential Tower), Patil & Mhatre C.A. Office, Dinesh Jain Luxury Residence
Studio Gang Architects / City Hyde Park
Lacol Architects / La Borda
Brooks & Scarpa Architects / The Six

Images - Photographs

Studio Abhishek Sawant / 01 (front cover), 10 & 11, 21 (left-above), 22 & 23, 24, 25, 26, 28, 30, 31, 32, 33, 34 & 35, 48 (left - above & below)
Caph Building Studio, LLP / 18 (above), 27 (all six), 29 (right - all), 37 (right- middle & below), 38 & 39 (flaps - in & out)
Re-arrange Homes / 48 (right - above & below)
NHK World, Japan / 10 & 11
Studio Gang Architects / 45 (left & right - below)
Lacol Architects / 46 (left & right - below)
Brooks & Scarpa Architects / 47 (all three)
Merino Industries Ltd. / 18 (below - representational image), 19 (below)

Images - 3D Visualization

Caph Building Studio, LLP / 19 (above), 21 (right - above & below), 21 (left - below), 27, (right - above), 29 (left - above, middle, and below), 36 (all), 37 (left - above, middle, and below), 37 (right - above), 38 & 39 (all)
Soyuz Talib Architects Pvt. Ltd. / 40 (right - above & below), 41 (left - above), 41 (right - above & middle)
BPP Architecture Workshop / 40 (left - above & below), 41 (left & right - below)
Studio Gang Architects / 45 (above)
Lacol Architects / 46 (above)

Printer

Silverpoint Press Pvt. Ltd., Mumbai & Navi-Mumbai

09 / STUDIO PROFILE

STUDIO

Caph Building Studio offers design services and construction consultancy as architects. It operates within architecture, interior, and landscape design projects from start to finish.

This studio was established in 2020 by Samir Bagdadi, building on varied experience in its field since 2011. Before its establishment, the earlier experience adds skills to the studio within the building design field. After its establishment, it has been working to extend skills within and beyond design fields.

METHOD OF WORKING

We consider two things to be responsible for in design with a client's requirements. It should serve them well, and their environment should meaningfully speak to them.

Our design focuses on people and their complex layers of needs. Visual appeal is a result of well-organized functions.

To serve our clients with a sufficient understanding of our workings and gain their trust at each step we take, we furnish them with digital and physical models. It keeps them well-informed on design progress and allows for their conscious decisions.

OUR CLIENT

We welcome an individual, a developer, a community, or practically anyone to be our clients. And fulfill their search for a suitable design solution through a specific design method tailored to every project. We pay attention to sensitive design as a rule to obey.

The project types and their scale in size and budget are open to this practice.

KEY PEOPLE

Samir Bagdadi
Founder & Architect
Dip. Interior Design & Decoration (Mumbai)
B. Architecture (Mumbai)
Pg.Dip. Environmental Design of Buildings (UK)
Glenn Murcutt Master Class (Australia)
M. Arch. Urban Design (Mumbai)

Harsh Nag
Associate Architect
B. Architecture (Mumbai)

Mehtab Bagdadi
Administrator
M. Com (Mumbai)

Nauman Roomaney
Business Developer
MBA Marketing (Mumbai)

CAPH BUILDING STUDIO, LLP

Meet
Office 205, NBC Complex
Plot-43, Sector-11, Belapur
Navi-Mumbai 400 614, India

Reach
(+91) 022 4016 2020
reach@caph-studio.com

Explore
Instagram / caphbuildingstudio
Web / www.caph-studio.com

Enquire
(+91) 8655 624 500
reach@caph-studio.com

Scan
For more info, scan QR below.
Use Camera or Google Lens App.
For digital version click on QR

A STATEMENT OF RESPONSIBILITY

The circulation of this journal does not intend any commercial gains. Its focus is to collect and share ideas on new forms of development. In return, to shape societies for better living.

Stories that build design builds you!

*As architects, we take your story to design spaces
in ways you live, work, and socialize
to shape you better.*

The ways we live, work and socialize change with time through larger forces in human societies. We moved from manual to electrical to digital and now automation. Such changes often affect us and our spaces.

Our purpose within societies keeps changing. So has our forms of shelter. Earlier, we sheltered in caves and later built huts. Now, construct buildings and their surroundings for us. Finding their new forms is a sign of human intelligence and progress. They should serve the better living.

In present times, what new forms of shelter shape better living environments?